



Telefax: 040-23393206
:04023378549

GOVERNMENT OF INDIA
MINISTRY OF ROAD TRANSPORT & HIGHWAYS

REGIONAL OFFICE;
Quality Control Building,
Errum Manzil,
Hyderabad-500082
Dated: 20.02.2019

No. RW/HYD/Misc.24/Access/RO/NH-65(9)/S.No.70/

949

Invitation of Public Comments

Sub: Proposal for grant of access permission to the proposed Private Property by M/s Beeram Madhavi at Km 182/047-287 (LHS, Survey No. 644/E3, 644/E42, 645/A8) of Hyderabad-Vijayawada Section of NH-65 (New NH No.9) of Village -Kodad, Mandal-Kodad, District-Suryapet in the State of Telangana.

The Project Director, NHAI, Hyderabad has submitted the proposal of M/s Beeram Madhavi mentioned in captioned subject vide letter no. NHAI/PIU-HYD/Hyd-Vij/Beeram/Access/2018/09 dated 04.01.2019 to this office for grant of NOC with relaxation against the norms Minimum Distance from intersection/ Median opening and take off point of an access which is 208m against 300m. The applicant has sought relaxation from Ministry Guidelines issued vide letter No.RW/NH-33023/19/99-DO.III dated 24.07.2013 based on justification at Annexure I.

2.0 As per Ministry vide OM No.RW/NH/33023/19/99-DO.III dated 16.03.2016, the Highway Administrator will make available the relaxation proposal of Private Property for public comments, and the comments will be invited within 60 days from the day of uploading.

3.0 In view of the above, the comments from public on the above mentioned proposal is invited on public portal for access permission to private property on website of Ministry and Road Transport and Highways (www.morth.nic.in) as per Form-A (copy enclosed).

The Chief Engineer-Regional Officer,
Ministry of Road Transport & Highways,
(R&B) Quality Control Building, 2nd floor,
Errum Manzil, Hyderabad - 500 082
Email Id: sehyderabad@gmail.com

Encl: As above

Yours faithfully,

(S. Vijaya Kumar)

Superintending Engineer

For Regional Officer cum Highway Administrator

Annexure-I

SI. No	State	NH No.	Chainage	Applicant	Deviation	Justification
1	Telangana	65 (old NH-9)	182/047-287 (LHS)	M/s Beeram Madhavi	Minimum Distance from intersection/ Median opening and take off point of an access which is 208m against 300m	Extension of the existing service road with length 675m (5.5m wide from Km 181/712 to Km182/387) to existing junction to avoid contra-flow movement of vehicle at their (Owner) cost as per IRC/ MoRTH Standards



Form for inviting public comments on the application for relaxation in the guidelines/norms for access permission to fuel stations, private properties, rest areas complexes and other such facilities along National Highways

Sub: Proposal for grant of access permission to the proposed Private Property by M/s Beeram Madhavi at Km 182/047-287 (LHS, Survey No. 644/E3, 644/E42, 645/A8) of Hyderabad-Vijayawada Section of NH-65 (New NH No.9) of Village - Kodad, Mandal-Kodad, District-Suryapet in the State of Telangana..

The comments by the general public needs to be given within 60 days of uploading the online application for comments

Sl. No	Item	Details
1	Name of the person who is desiring to give comments	
2	Address of the person	
3	Details of the application for access permission against which comments are being given (name of applicant and other details like site address etc.)	
	a) Application No.	
	b) Name of applicant (who applied to access permission)	
	c) Details of Application	
4	Whether the specific permission if given, shall cause any damage to Highways? If yes, please give details	
5	Whether specific permission if given, shall adversely affect safety and convenience of the traffic on the Highways? If yes, please give the details.	
6	Whether specific permission if given, shall adversely affect hygiene or cause nuisance and pollution on the Highways? If yes, please give the details.	

CHECK LIST

{Enclosure to Ministry of Road Transport & Highways letter No RW/NH-33023/19/99-DO III dated 24.07.2013}

Check list for getting approval for access permission to private properties along National Highways

- 1.0 General information
- 1.1 National Highway Number : NH-65(OLD NH-9)
- 1.2 State : TELANGANA
- 1.3 Location : KODAD
- 1.3.1 (Chainage in km) : Km 182/047-287(Hyderabad-Vijayawada Section)
- 1.3.2 [Side of the NH(Left or Right side of NH towards increasing chainage/Km/direction)] : LHS
- 1.4 Name of Highway Authority (NHAI/PWD/BRO) : NHAI, PIU-HYDERABAD
- 1.5 Highway Administration Address : The Regional Officer
Ministry of Road Transport Highways
Quality Control Building
2nd Floor, Errum Manzil Colony, Hyderabad-82
- 1.6 Name of Oil Company (as applicable) : BEERAM MADHAVI
Name and address of Owner of Retail Outlet/Private Property: : 10-10/15,SRINIVASA GAYATRI NAGAR,JILLELAGUDA,
SAROOR NAGAR,MEERPET,HYDERABAD-500097

Location & Layout, Drainage, Road Signs and Markings requirments for access connection to Residential Properties (RP) and Other properties (OP) in Urban, Built up & Rural Reaches

Sl.No.	Description	Urban/Built up reaches	Rural reaches	Measurment at Site (URBAN) <i>Small left</i>	Remarks
	Minimum Distance Between merging points of a service road including acceleration & deceleration lanes of 100m and 70m respectively	Minimum 500m/minimum 1000m (in case of National Highways to be developed as Expressway)	Minimum 750m/minimum 1000m (in case of National Highways to be developed as Expressway)	788M	YES (We propose to extend the service road of 788M length as per norms of MORTH, access to be taken only from the proposed service road as shown in the layout.)
	Minimum Distance Between merging points of two access on the same side of carriage way.	100m	300m	2010M	YES
2	Minimum distance from intersection/Median opening and take off points of an access.	100m	300m	208M	YES
3	Minimum Distance Between merging points of two access on the opposite side.	In case of undivided carriage way it is preferred to have access connection to properties on opposite side of carriageways, which are exactly opposite to each other, to have minimum distraction to NH Traffic. For divided carriageway no such restriction applies.-NA			

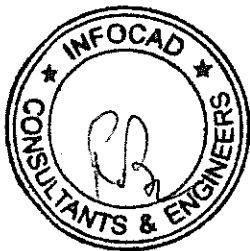

B. madhavi
Owner of Property

Project Director
NHAI, PIU
HYDERABAD

Sl.No.	Description	Urban/Built up reaches	Rural reaches	Measurement at Site (URBAN)	Remarks
4	Minimum distance from Tollgate	1000m	1000m	22835M	YES
5	Minimum distance from Railway crossing	300m	300m	more than 300m	If distance is less than the distance specified, service road to be provided/extended (which can be left with a dead end also)
6	Width of entrance/exit	Minimum 9m Maximum 12m		9.0m	
7	Radius of Turning Curve	Minimum 13m Ruling 30m		13.0m	
8	Radius of Non-turning curve	Minimum 1.5m Maximum 3m		3.0m	
9	Length of acceleration line	100m		We propose to extend the service road of 788M length as per norms of MORTH, access to be taken only from the proposed service road as shown in the layout.	For Other Properties only
10	Length of deceleration line	70m		70.0M	
11	Width of acceleration line	5.5m minimum		We propose to extend the service road of 788M length as per norms of MORTH, access to be taken only from the proposed service road as shown in the layout.	
12	Width of deceleration line	5.5m minimum		5.50M	
13	Width of Service Road	5.5m -7m		5.50M	
14	Crust composition of Service Road & Acceleration & Deceleration lane	Minimum 150 mm thick Granular Sub-base (GSB) overlaid by three layers of Water Bound Macadam (WBM), each of 75mm thickness overlaid by bituminous surfacing of minimum thickness 20mm.		YES	
15	Crust composition of access connection/ extend service road for Residential Properties	At least Gravel road		NA	For Residential Properties only
16	Width of access connection/ extend service road to Residential Properties	Minimum 3.5m		NA	
17	Radius of Turning Curve	Minimum 13m Ruling 30m		NA	

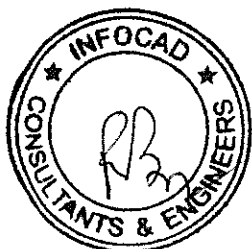

B. madhavi
Owner of Property

Project Director
NHAI, PIU
HYDERABAD.

Sl.No.	Description	Urban/Built up reaches	Rural reaches	Measurment at Site (URBAN)	Remarks
	Road Signs(According to IRC:67)				For Other Properties only
18	Side Road Sign on NH before Deceleration lane	To be provided		YES	
19	Appropriate facility information sign (i.e Hospital,Eating place etc.)	To be provided		YES	
20	One way sign on left side of the Deceleration & Acceleration lanes	To be provided		YES	
21	No parking sign on left side of the Deceleration & Acceleration lanes	To be provided		YES	
22	No entry Sign on right side of the Deceleration lane at its connection with service road	To be provided		YES	
23	Appropriate No. of Right turn prohibited signs on right side of service road in front of Property Plot(facing the property)	To be provided		YES	
24	Give way sign with Give way line marking according to IRC:35 on left side of the acceleration lane at 30 m before its connection with NH	To be provided		YES	
25	No left turn sign on NH before its connection with Acceleration lane	To be provided		YES	
26	No right turn sign on Right side of NH in case of Undivided carriageway	NA		NA	
	Road Markings(According to IRC:35)				
27	Marking for parallel acceleration lane	To be provided		YES	For Other Properties only
28	Marking for tapered deceleration lane	To be provided		YES	
	Drainage Requirements				
29	Provision of Culvert for drainage in accordance with IRC SP-13	RCC Slab culvert		YES	For Both Residential Properties & Other Properties
30	Provision for intercepting drain with vertical drain system for Rain water harvesting at the down stream end of intercepting drain (According to Appendix A-2 of IRC:SP :50)	Provided		YES	
31	Downward slop of the access road towards the intercepting drain	Minimum 2%		YES	

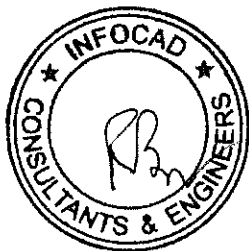

F B madhavi
Owner of Property

Murali
Project Director
NHAI, PIU
HYDERABAD.

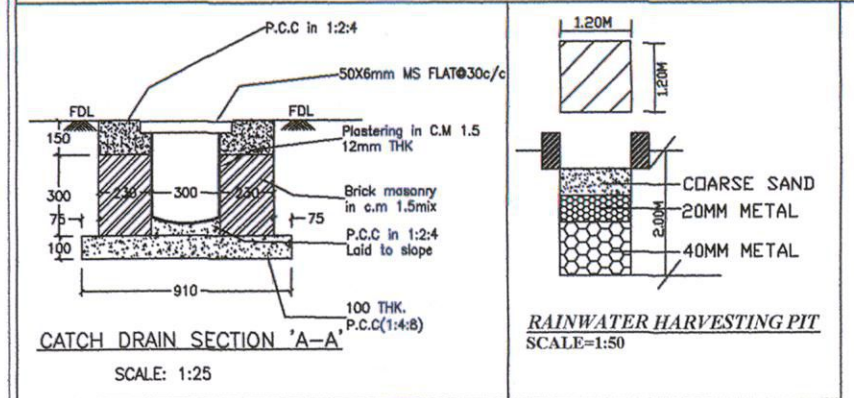
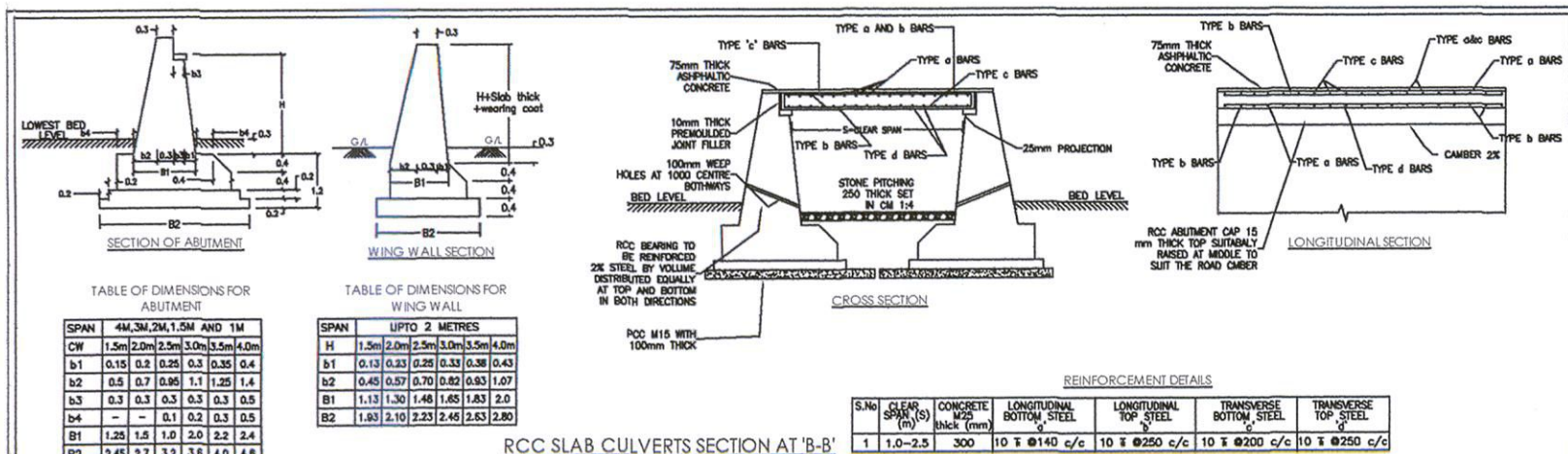

LOCATION:
 SURVEY NO.:****
 VILLAGE :KODAD
 MANDAL :KODAD
 DISTRICT :SURYAPET
 STATE :TELANGANA
 ROAD ON :NH-65(Old NH9)
 CHAINAGE :182/047-287
 (HYDERABAD-VIJAYAWADA SECTION)

- | | |
|------------------------|--------------------|
| (A) RESIDENTIAL LAYOUT | (E) NO RIGHT TURN |
| (B) ONEWAY | (F) GIVEWAY |
| (C) NO PARKING | (G) NO LEFT TURN |
| (D) NO ENTRY | (H) SIDE ROAD SIGN |

 SURVEY NO.:644/E3,644/E4/2,645/A8,645/A4/3,644/E3/1,644/E4/1,645/AA6,
 645/AA8/2,643/E6/3,644/E3/5,645/A9/1,644/E4/3,645/A7,645/A7/1

BEERAM MADHAVI
 10-10/15,SRINIVASA GAYATRI NAGAR,JILLELAGUDA,
 SAROOR NAGAR,MEERPET,HYDERABAD-500097

SUBJECT :
 PLAN SHOWING THE DRAINAGE PLAN OF
 PROPOSED PRIVATE PROPERTY @KODAD ALONG
 NATIONAL HIGHWAY@Km 182/047-287 OF NH-65(LHS)
 (OLD NH9)(HYDERABAD-VIJAYAWADA SECTION)

SCALE : 1:600	Consultants/Architects	OWNER:
DRAWN : MKR	INFO CAD CONSULTANTS/ENGINEERS 27-1-1075/3,RAMJI NAGAR NELLORE-524 002, A.P., www.infocad.in	DRAWING NO. PP/SP/01
DATE:03/01/19		

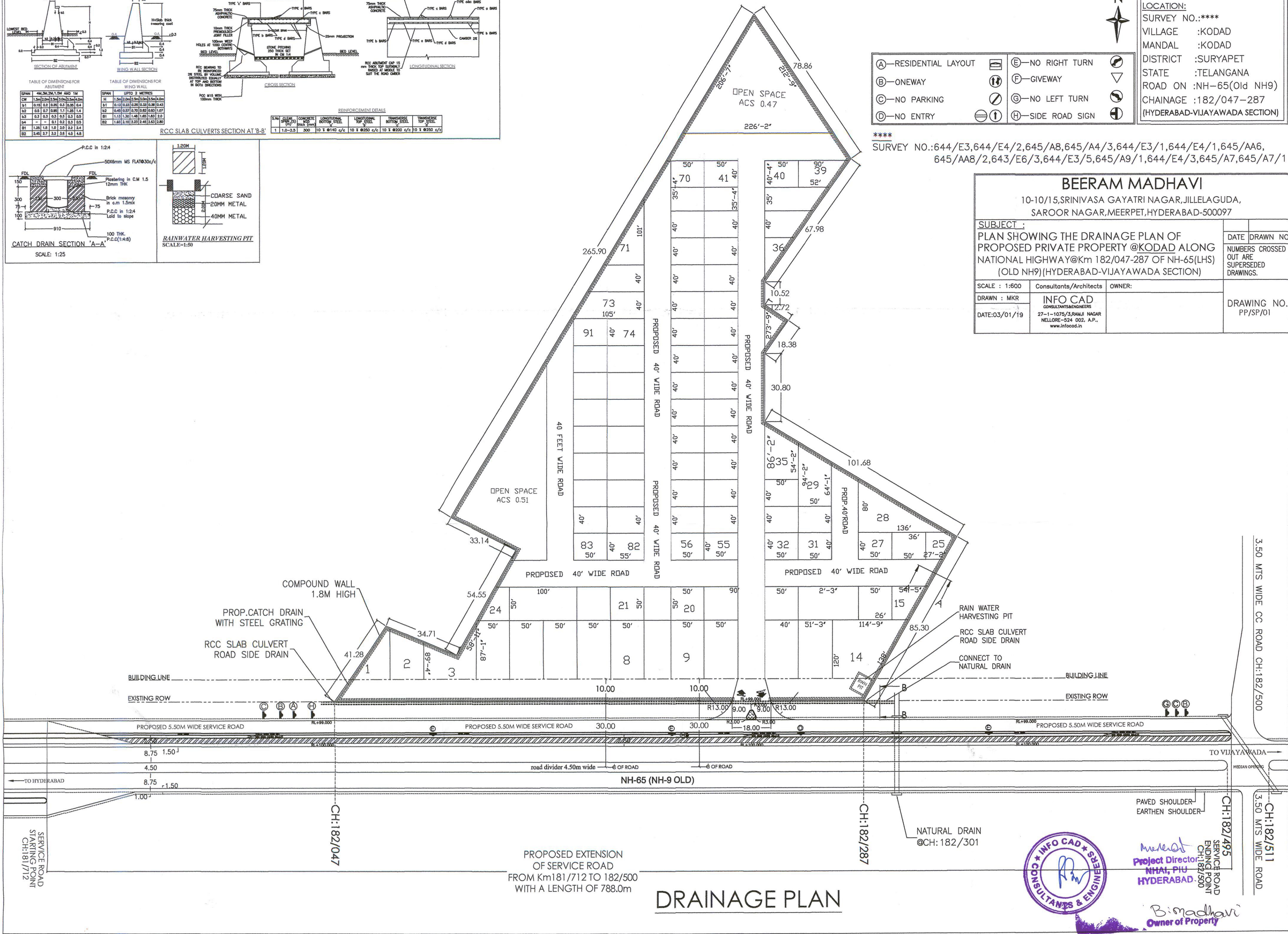

DRAINAGE PLAN



Project Director
**NHAI, PIU
 HYDERABAD**
Owner of Property
Bimadhavi

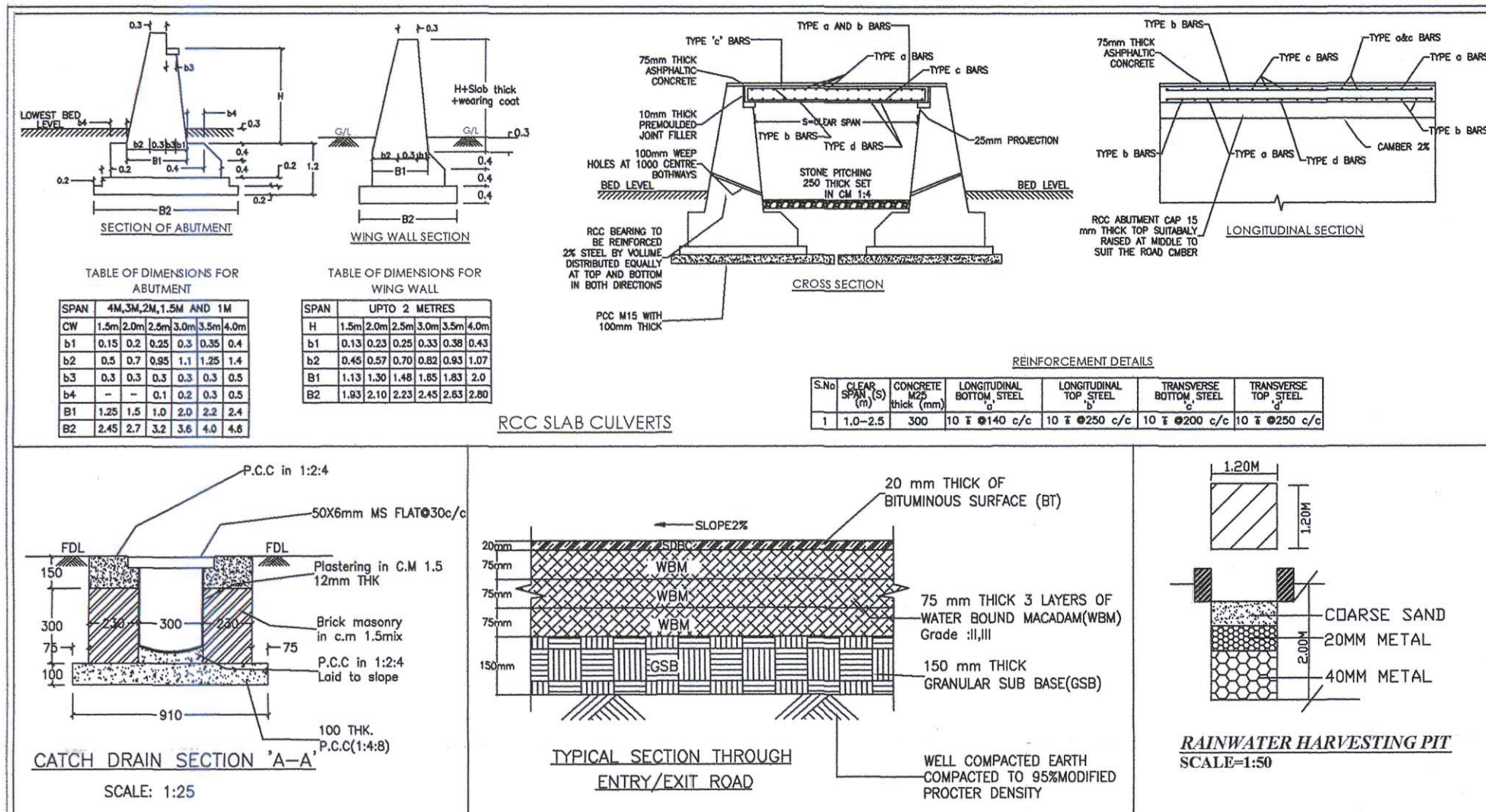

SURVEY NO.:644/E3,644/E4/2,645/A8,645/A4/3,644/E3/1,644/E4/1,645/AA6,645/AA8/2,643/E6/3,644/E3/5,645/A9/1,644/E4/3,645/A7,645/A7/1

LOCATION:
SURVEY NO.:****
VILLAGE :KODAD
MANDAL :KODAD
DISTRICT :SURYAPET
STATE :TELANGANA
ROAD ON :NH-65(Old NH9)
CHAINAGE :182/047-287
(HYDERABAD-VIJAYAWADA SECTION)

- (A)-RESIDENTIAL LAYOUT
(B)-ONEWAY
(C)-NO PARKING
(D)-NO ENTRY
- (E)-NO RIGHT TURN
(F)-GIVEWAY
(G)-NO LEFT TURN
(H)-SIDE ROAD SIGN

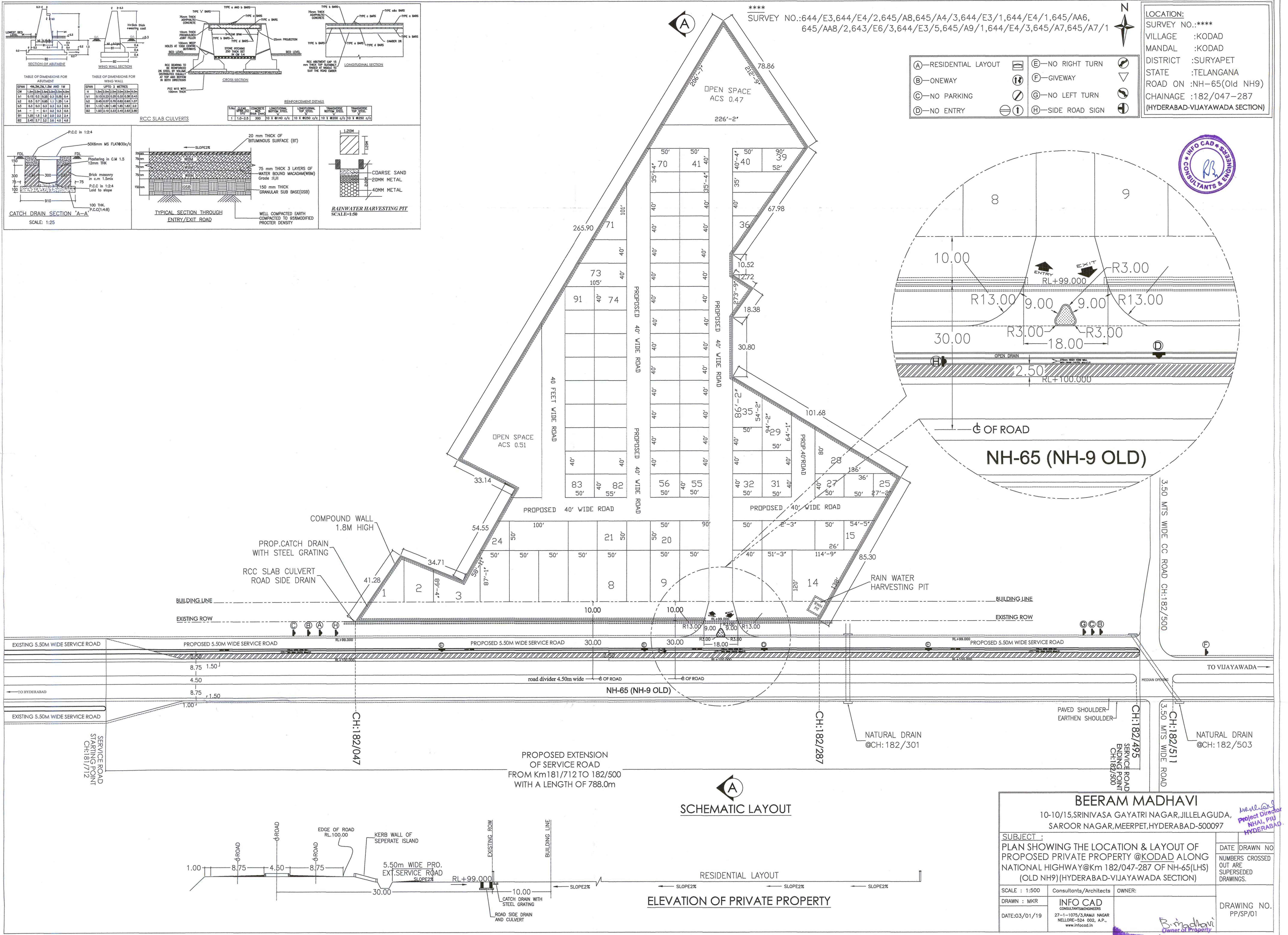

KODAD TOWN

SURVEY NO.:644/E3,644/E4/2,645/A8,645/A4/3,644/E3/1,644/E4/1,645/AA6,645/AA8/2,643/E6/3,644/E3/5,
644/E4/3,645/A9/1,645/A9/1,645/A7,645/A7/1



LOCATION:
SURVEY NO.:****
VILLAGE :KODAD
MANDAL :KODAD
DISTRICT :SURYAPET
STATE :TELANGANA
ROAD ON :NH-65(Old NH9)
CHAINAGE :182/047-287
(HYDERABAD-VIJAYAWADA SECTION)

AGRICULTURAL LANDS

AGRICULTURAL LANDS

AGRICULTURAL LANDS

R1.0km

PROPOSED
RESIDENTIAL
LAYOUT

208M

TO VIJAYAWADA

TO HYDERABAD

TO MELLA CHERUVU-VILLAGE

TO GUDI BANDA

MEDIAN OPENING
CH:182/495-511

SERVICE ROAD
ENDING POINT
CH:182/500

PROPOSED EXTENSION
OF SERVICE ROAD
FROM Km181/712 TO 182/500
WITH A LENGTH OF 788.0m

PROPOSED SITE
TO BE LICENCED

AGRICULTURAL LANDS

Project Director
NHAI, PIU
HYDERABAD

TOPO PLAN
SCALE:1:7500

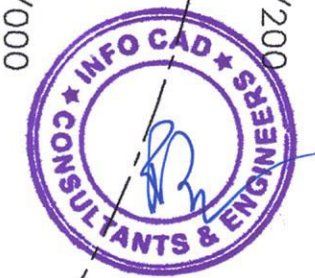

BEERAM MADHAVI

10-10/15,SRINIVASA GAYATRI NAGAR,JILLELAGUDA,
SAROOR NAGAR,MEERPET,HYDERABAD-500097

SUBJECT :
PLAN SHOWING THE LOCATION OF
PROPOSED PRIVATE PROPERTY @KODAD ALONG
NATIONAL HIGHWAY@Km 182/047-287 OF NH-65(LHS)
(OLD NH9)(HYDERABAD-VIJAYAWADA SECTION)

DATE
DRAWN NO
NUMBERS CROSSED
OUT ARE
SUPERSEDED
DRAWINGS.

SCALE : 1:7500
DRAWN : MKR
DATE:03/01/19
CONSULTANTS/Architects
OWNER:
INFO CAD
CONSULTANTS & ENGINEERS
27-1-1078/3 RAMJI NAGAR
NELLORE-524-002, A.P.,
www.infocad.in
DRAWING NO.
PP/SP/01

B. madhavi
Owner of Property